

# Access statement from Garden Organic

This access statement does not contain personal opinions as to our accessibility but aims to accurately describe the facilities and services that we offer all our visitors.

The Trustees take their responsibility for providing universal access provision very seriously and adhere to the Equality Act accordingly. We work hard to provide the highest level of access to the whole site.

## Our Vision and Values

Our **vision** is of a healthy and sustainable world that has embraced organic growing.

Our **mission** is to promote organic gardening, focusing on individual, community and school gardens throughout the UK. We will use innovative practices to inspire and encourage people to grow organically, collaborating with others to achieve the greatest impact.

Our **purpose** is to get more people growing organically.

Our HQ at Ryton is a unique place to work and visit and we want as many people as possible to access and enjoy our inspirational organic demonstration garden, the Heritage Seed Library and learn how to cultivate your own thriving organic, sustainable growing space. Please get in touch and let us know how we can make suitable adjustments for your visit, and we welcome feedback on how we can improve your experience.

## Pre-Arrival

Ryton Organic Gardens is 6.5 miles southeast of Coventry, off the A45, 1 mile from Wolston village. Our 'How to get here' page on our website includes a map link: [Garden Organic | How to get to Ryton Gardens](#)

Ryton Gardens has a clearly signposted entrance on Wolston Lane:



There are footpaths on Wolston Lane but limited pedestrian access or cycle paths on the approach from the A45.

The nearest railway station is Coventry, approx. 6 miles from Ryton Gardens.

The nearest bus stop is in Wolston Village situated on School Street approximately 0.8 miles from Ryton Gardens. There are no buses that directly pass the gardens.

Taxis are available to book via a member of staff. Allens Taxis are a local company who can also provide accessible taxis and can be contacted on 02476 555 555.

To plan your journey by car you can use [www.theaa.com/route-planner/route](http://www.theaa.com/route-planner/route) Simply enter your postcode and ours (CV8 3LG) to get directions.

### **Appropriate Clothing**

As many of our events will be outdoors, we advise you to wear sensible clothing appropriate to the course description and anticipated seasonal weather.

Please note that some walkways and areas of the gardens are uneven, so we also advise that you wear suitable footwear.

### **Car Parking and Arrival**

We have 25 car parking spaces including 2 clearly marked/signposted blue badge spaces. These are opposite the main building:



The carpark surface is flat tarmac with raised stone flag pathways which slope down gently. There are various raised flower/grass beds connected to the pathways. The footpath over the tarmac car park is clearly marked in yellow with a pedestrian sign.



The drop off point for taxis is directly outside the main building.

There are tall car park lamps which illuminate automatically making visibility clear at night and in the early mornings.

The pathways around the building are flat, even stone flags and the carpark is level tarmac with clearly visible lines for cars and pedestrians.

The Garden Organic entrance is situated at the right-hand corner of the main building:



Please proceed through the wooden archway and follow the path to the right. Please ring the doorbell and a member of staff will greet you. There are no steps or inclines to reach the door and it is a short walk over a stone flag pathway.

## **Indoor Facilities**

All areas inside are accessible by wheelchair and the floor is lino and level throughout.

The area is evenly and well-lit with overhead lighting.

There is a deep, single step down at one rear exit from the main building into the garden, however, alternative step-free access is available.

## **The Gardens**

Please note that the garden is a working environment, and so conditions may be different on the day. Please take care of uneven surfaces, trip hazards or objects that may cause an obstruction.

Some events may have more limited accessibility in some outdoor areas; however, this will always be clearly stated in the event information if applicable.

Most of the garden surfaces are accessible. However, there are small amounts of gravelled areas which may be difficult to manoeuvre over. All pathways, doors and gates throughout the garden are wide enough to accommodate a wheelchair.

There are several areas of the garden which are covered with grass. Some areas may only be accessible by travelling across the grass which can be uneven and bumpy.

The entrance/exit to the gardens is via a gateway between the outdoor classroom and main entrance and is level throughout.

Benches and chairs are located at various points around the garden. A covered seating and table area is available for visitors to enjoy.

The garden includes pond areas. Please take care whilst around open water. Your course instructor/guide will show you where the pond is during your visit.



Ornamental Garden Pathway



Grass Pathway

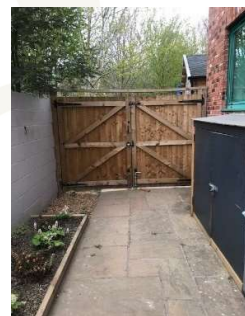

Gate to enter/exit garden

## Visits to the Heritage Seed Library working areas

Some events, where specified, include visits to the Heritage Seed Library (HSL) working areas at a different part of the Ryton site, where there are restrictive spaces and uneven surfaces. These may include:

- The seed cold store, seed cleaning room and drying room – narrow access in places.
- External paths in HSL growing spaces – uneven grass and gravel surfaces, slopes, and narrow paths. Some areas may only be accessible by travelling across the grass which can be uneven and bumpy.
- Polytunnels and cages – steps and narrow access into and inside polytunnels and cages (mypex paths less than 50cm wide). Obstacles such as irrigation pipes and sprawling plants. Warm and humid on sunny days.
- Glasshouse – concrete flooring. Some narrow spaces (less than 50cm wide) between moveable work benches at fixed height.
- Up to 200m walk from external toilet block.
- Up to 250m walk from main building (vehicle access drop off may be available via service road).



External growing spaces



Typical Polytunnel



Seed Cold Store

## Public Toilets

Three toilets are located within the main building including one which is accessible.



Toilets are not externally locked and there is no key required to open them.

All toilets are bright and evenly lit.

The toilet is fitted with grab rails. One is situated to the right of the toilet and is a drop-down variety and there are two either side of the sink.

There are no steps to access the toilets and floors are flat and level throughout.

If guests require assistance there is an emergency call system activated by a red cord to the right side of the toilet.

The sink is low enough to be accessible by wheelchairs and is fitted with lever taps.

We also have use of an outdoor toilet block which will be highlighted to you during the health and safety briefing if in operation.

### **First Aid**

Many of our staff are first aid trained. There will always be someone on site and available who is first aid trained at all events.

First aid kits can be found in the main office, the staff break-out room, the gardeners shed, the facilities coordinators shed and the HSL potting shed. All of our first aid kits are fully stocked and checked regularly.

If you were to have a near-miss, accident, or injury whilst on site please report it to one of our staff members, however small it may be, so that it can be reported to prevent future occurrences.

If there was an accident or injury it would be reported on our online system 'SafeHR'.

Prior to your session you will be provided with a 'Fire and safety briefing'. This will highlight site procedures and key staff members.

### **Fire Procedures**

There will always be a trained Fire Marshal on site and many of our staff have fire awareness training.

If you locate a fire and it is safe to do so – sound the alarm or let a member of staff know. Leave by the nearest exit and go to the assembly point.

The assembly point is located in the car park situated near the hedges by the road.



If there is a fire, please leave any belongings and proceed calmly to the assembly point. Do not return to the building for any reason until authorised to do so by a fire marshal.

Prior to your session you will be provided with a 'Fire and safety briefing'. This will highlight site procedures and key staff members.

### **Covid 19 and other illness**

We have numerous procedures in place in reaction to Covid 19 including our risk assessments.

If you are feeling unwell or have recently experienced any symptoms of illness, we would ask that you let us know and do not attend the event as a precaution.

Please wash your hands frequently and correctly (for at least 20 seconds) when onsite.

Hand sanitiser is provided at all entrances to the building.

### **Smoking**

The Organisation has a policy that prohibits smoking, including the use of E-Cigarettes, except in the designated outside areas. Smoking is not permitted in the garden areas. This applies to all employees and visitors to the premises.

### **Refreshments**

Please check individual event descriptions for details on catering and refreshments provided.

We encourage you to bring your own bottled drinks, particularly during the hotter summer months.

Where refreshments are provided, we strive to provide organic and locally produced food when possible.

We do our best to cater for any dietary requirements; please highlight any allergies or dietary requirements you may have at the earliest opportunity.

Guests are welcome to take refreshments (where provided) to the outside seating areas to enjoy.

Crockery provided is colour contrasted with the table where possible.

### **Indoor facilities**

Tables in the 'Bocking' meeting & training room are well spaced apart with enough room to accommodate a wheelchair or pushchair.

There is natural light in the meeting rooms. It is evenly and well lit.

The flooring is lino and level and even throughout.

### **Website**

If you need any information on our website in a different format (such as an accessible PDF, large print, easy read, audio recording or braille) please get in touch.

We want as many people as possible to be able to use our website. Currently, you should be able to:

- Change colours, contrast levels and fonts
- Zoom in up to 300%, without text flowing off-screen.
- Navigate the website using just a keyboard
- Navigate the website using speech recognition software
- Listen to this website using a screen reader (including recent versions of JAWS, NVDA and VoiceOver).

AbilityNet has advice on making your device easier to use if you have a disability - [Simple 'how to' guides to make your device easier to use | My Computer My Way \(abilitynet.org.uk\)](https://abilitynet.org.uk)

Our website is compliant with the Web Content Accessibility Guidelines version 2.1 AA Standard, and we treat that as the minimum acceptable while aiming to achieve compliance with the AAA standard.

We are always looking to improve the accessibility of our website. If you have any problems accessing this site, or you think we are not meeting accessibility requirements please get in touch.



### **Additional Information**

Staff will be available to assist you at any time.

Assistance dogs are welcome in all areas. Please let us know if you are planning to visit with an assistance dog.

We have a set of evacuation procedures should you require it. These can be made available in large print upon request. We will run through relevant health and safety procedures with you at the beginning of an event.

Clear signage is used throughout the site. Please follow the instructions on these signs and adhere to any guidelines.

Parents or guardians must take full responsibility for their children whilst on site. Please bear in mind that it is a working garden with open water sources. Not all sessions are suitable for children. Please contact us for more information if in doubt.

If you have any impairments or disabilities that you need to make us aware of, please get in touch and let us know so we can make suitable adjustments for your visit.

### **Contact Information**

**Address:** Garden Organic, Ryton Gardens, Wolston Lane, Coventry, Warwickshire, CV8 3LG

**Telephone:** 02476 303 518

**Email:** [enquiry@gardenorganic.org.uk](mailto:enquiry@gardenorganic.org.uk)

**Website:** [www.gardenorganic.org.uk](http://www.gardenorganic.org.uk)

**Local equipment hire:** Mobility Pathways, Barracks Car Park Upper Precinct, Coventry, CV11 1DD. Telephone: 02476 832 020

**Local accessible taxi:** 02476 555 555

### Building Map

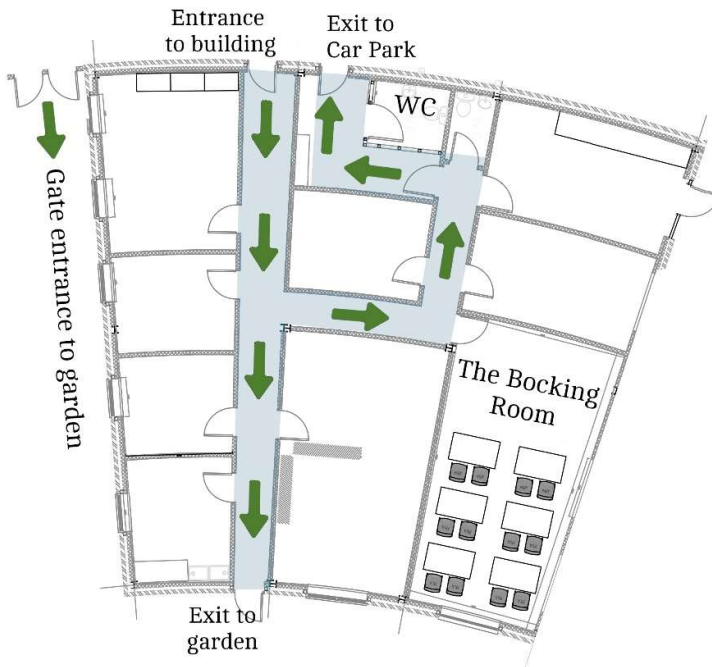

### Garden Map

